

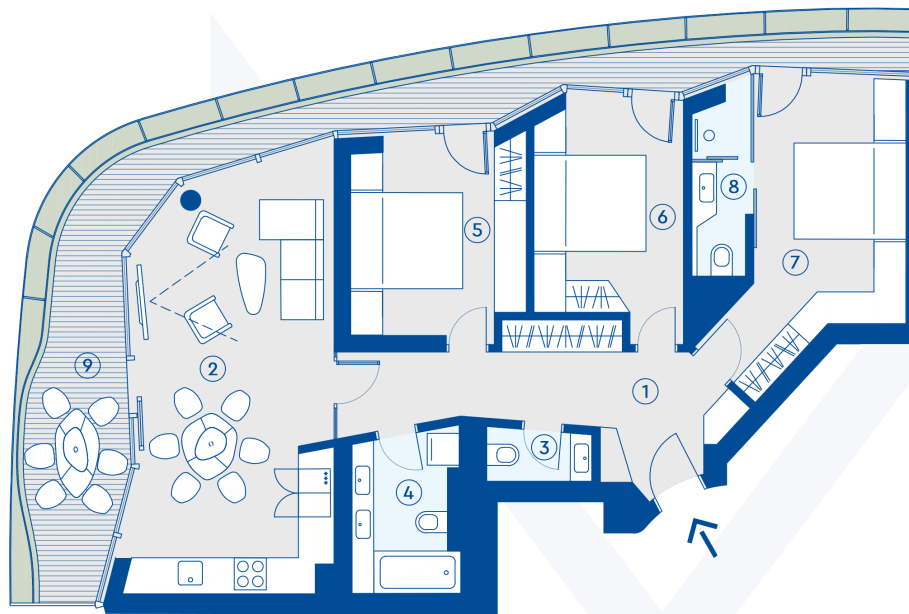

MARINA DORĆOL

3BR apartment

| | |
|-------------------|----------------------------|
| 1 Entrance hall | 13.6 m ² |
| 2 Living room | 29.3 m ² |
| 3 Toilet | 1.9 m ² |
| 4 Bathroom | 5.7 m ² |
| 5 Bedroom 1 | 12.0 m ² |
| 6 Bedroom 2 | 14.3 m ² |
| 7 Master bedroom | 15.6 m ² |
| 8 Master bathroom | 3.3 m ² |
| <hr/> | |
| Total apartment | 95.7 m ² |
| 9 Terrace | 22.8 m ² |
| <hr/> | |
| Total: | 118.5 m² |



All stated floor areas are approximate and subject to normal construction variances and tolerances. Fit-out of the apartment shown on floor plan (such as furniture, kitchen including appliances, build in wardrobes, etc.) is for presentation purposes only, not included in the price of apartment.

